

**SILVERCRAFT**  
FISHING BOATS & FAMILY CRUISERS

P R O D U C T   O V E R V I E W



# SILVERCRAFT FLEET

---



SILVERCRAFT 31



SILVERCRAFT 31 CC



SILVERCRAFT 31 HT



SILVERCRAFT 33



SILVERCRAFT 36 CC (Cuddy Cabin)



SILVERCRAFT 36 CC (Open)



SILVERCRAFT 36 HT



SILVERCRAFT 40

# ABOUT SILVERCRAFT

Year after year, we're striving to exceed our customers' expectations. That's why we created the new Silvercraft fishing boats and family cruisers. Continuing the Gulf Craft reputation for constant innovation and superior standard quality, the Silvercraft fleet combines advanced hull designs, superior performance and evolving styles.

With thousands of recreational craft cruising the seas, the company can proudly reflect on a proven track-record and loyal customer base. Built on the sea-faring traditions of the region and its own powerboat racing heritage, Gulf Craft has rapidly developed into one of the leading fiberglass powerboat builders worldwide.

With the company founders being seasoned seafarers themselves, every new boat type is carefully designed and rigorously tested before introduction to the market. The strive for application of the latest technologies and to meet the design requirements of our customers spread all over the globe, is forcing a constant rejuvenation and rethinking of the production process and product.



SILVERCRAFT 34



SILVERCRAFT  
34





## DECK PLANS

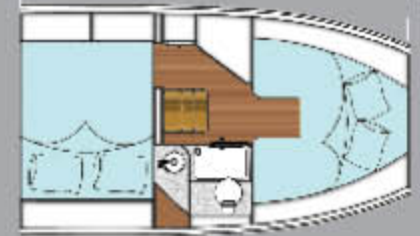
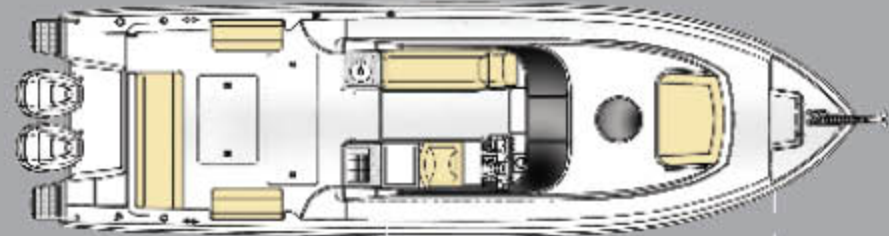

## SPECIFICATIONS

|                     |                          |
|---------------------|--------------------------|
| Length overall      | 34 ft 2 in (10.30 m)     |
| Beam                | 9 ft 9 in (3.00 m)       |
| Draft               | 1 ft 6 in (0.50 m)       |
| Displacement        | 7,050 lbs (3,200 kg)     |
| Fuel capacity       | 180 US gal (680 l)       |
| Max. horsepower     | 600 hp                   |
| Max. no. of persons | 13 persons               |
| Max. load           | 3,306 lbs (1,500 kg)     |
| Safety regulation   | US Coast Guard Standards |

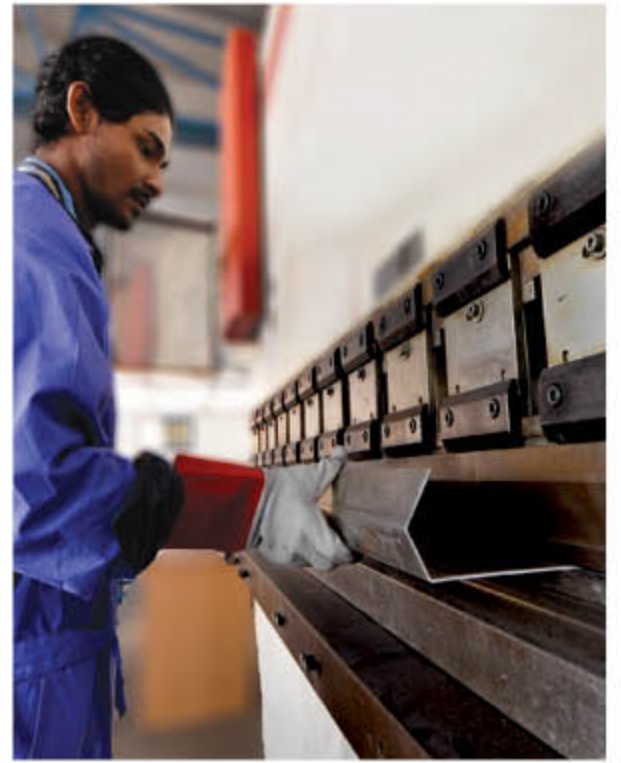



## CRAFTSMANSHIP

Engineering, automation technology and artisanal craftsmanship are all rolled into one at Gulf Craft's shipyards.

## TECHNOLOGY

Gulf Craft's ongoing technological investments have significantly contributed to the improvements in its boats. The Silvercraft range has also seen its share of technology with the utilization of CNC machines and waterjet cutting equipment.



# SILVER CRAFT



by *Gulf Craft*

PO Box 666, Ajman - U.A.E. T. +971 6 7406060 F. +971 6 7406062  
[www.silver-craft.com](http://www.silver-craft.com) [contact@silver-craft.com](mailto:contact@silver-craft.com)